



**Reliable Floor Care**  
 W229N1680 Westwood Dr, Ste B  
 Waukesha, WI 53186  
 Office: (262) 558-5000

**Proposal**

Date:	Order No.
2/26/2024	27217

ReliableFloorCare.com

Customer Information	Service Location	Reliable Floor Care Rep:	
Name: River Valley School District Phone: - Loren Glasbrenner	Elementary, MS, HS  Spring Green, WI 53588	<b>Sam Hughes</b>	(608) 888-8082

**Floor Restoration Project**

Our promise to you is that our work is 100% guaranteed! We never compromise on quality and our team is professional, safe and friendly!

**VCT & 9x9 Tile Restoration (Recommended Services)**

*\*Marked Blue on attached maps*

**Elementary**

VCT- Rooms: 126, 130, 131, 133-136 \$5,828

**Middle School**

9x9- Rooms: 10, 20-28, 54-57, Copy Room \$11,613

VCT- Rooms: Rms 5-7, 19, Counselor, Main Office Hallway \$2,023

**High School**

9x9- Rooms: 13-15, 17, 18, 21-23 \$6,701

VCT- Rooms: 12, 16, 19-20, 24-34, 52-55, 57, 59-65, 69-71, Locker Room Entrances (2) \$28,143

(3 coats of floor finish applied)

**Total VCT & 9x9 \$54,308**

**Terrazzo (Recommended Services)**

*\*Marked Green on attached maps*

**High School**

Hallways (Corridors and Vestibules) and Cafeteria (~22,000 sqft)\* \$99,873

**Total Terrazzo \$99,873**

**OPTIONAL: Terrazzo Repairs (Not to exceed Budget, not included in Project Total)**

High School - Entrance A Repairs (See attached for details) \$3,390

High School - NO specific repairs listed - BUDGET Suggestion \$28,665

Repairs Total \$32,055

**Project Total\* \$154,181**

Total w/ Terrazzo Repairs \$186,236

\*Project Total does NOT include the Repairs. Color matched isn't a perfect match. Remaining cove base in the hallway prevents our machines from getting within 1/2" of cove base.

Signature \_\_\_\_\_ Date \_\_\_\_\_

All items are subject to the standard tax rate. Please make checks payable to Reliable Floor Care, LLC (RFC). A \$50 fee for NSF checks. All invoices are payable within 30 days of invoice date and there may be a 10% interest charge added to balances that are beyond 10 days overdue. RFC is NOT responsible for pre-existing conditions that may become present after the work is performed. By signing this form, I agree that I am authorized to have this work performed at the above service location and agree to the terms of RFC, found at [ReliableFloorCare.com/terms](http://ReliableFloorCare.com/terms). RFC will perform the work agreed to within a timely manner. Some services have minimums and cannot be chosen a la carte. Thank you for your business and the opportunity to serve you!



**Reliable Floor Care**  
 W229N1680 Westwood Dr, Ste B  
 Waukesha, WI 53186  
 Office: (262) 558-5000

**Proposal**

Date:	Order No.
2/26/2024	27217

ReliableFloorCare.com

Customer Information	Service Location	Reliable Floor Care Rep:
Name: River Valley School District Phone: - Loren Glasbrenner	<b>RV Schools</b> 660 Varsity Blvd Spring Green, WI 53588	<b>Sam Hughes</b> (608) 888-8082

<p><b><u>VCT (Vinyl Composition Tile)</u></b></p> <p>Our promise to you is that our work is 100% guaranteed! We never compromise on quality and our team is professional, safe and friendly!</p> <p><b>RV Elementary School</b></p>	<p><b>Durable Protection</b></p> <p>Protect all corners Use walk off mats <b>Scrub Floor</b> Use Flat mop to prevent finish on cove base <u>Standard Floor Finish</u></p> <p>(Good)</p>	<p><b>New Look Protection</b></p> <p>Protect all corners Use walk off mats <b>Strip Floor Finish</b> Use Flat mop to prevent finish on cove base Standard Floor Finish</p> <p>(Better)</p>	<p><b>New Look Ultra Protection</b></p> <p>Protect all corners Use walk off mats <b>Strip Floor Finish</b> Use Flat mop to prevent finish on cove base <b>RFC Vinyl Care System</b> (Never strip again!)</p> <p>(Best)</p>
	<p><b>VCT Tile (12" x 12")</b> Rooms: 126, 130, 131, 133-136</p> <p>\$3,040</p>	<p>\$5,828</p>	<p>\$8,462</p>
(taxes included) <b>Total</b>	<b>\$3,040</b>	<b>\$5,828</b>	<b>\$8,462</b>

**Recommended!**

**Job Order Notes:**

\*All items removed from floor prior to arrival or additional charges may apply.

Signature \_\_\_\_\_ Date \_\_\_\_\_

All items are subject to the standard tax rate. Please make checks payable to Reliable Floor Care, LLC (RFC). A \$50 fee for NSF checks. All invoices are payable within 30 days of invoice date and there may be a 10% interest charge added to balances that are beyond 10 days overdue. RFC is NOT responsible for pre-existing conditions that may become present after the work is performed. By signing this form, I agree that I am authorized to have this work performed at the above service location and agree to the terms of RFC, found at ReliableFloorCare.com/terms. RFC will perform the work agreed to within a timely manner. Some services have minimums and cannot be chosen a la carte. Thank you for your business and the opportunity to serve you!



**Reliable Floor Care**  
 W229N1680 Westwood Dr, Ste B  
 Waukesha, WI 53186  
 Office: (262) 558-5000

**Proposal**

Date:	Order No.
2/26/2024	27217

ReliableFloorCare.com

Customer Information	Service Location	Reliable Floor Care Rep:	
Name: River Valley School District Phone: - Loren Glasbrenner	<b>RV Schools</b> 660 Varsity Blvd Spring Green, WI 53588	<b>Sam Hughes</b>	(608) 888-8082
<p><b><u>VCT (Vinyl Composition Tile)</u></b></p> <p>Our promise to you is that our work is 100% guaranteed! We never compromise on quality and our team is professional, safe and friendly!</p> <p><b>RV Middle School</b></p>	<p><b>Durable Protection</b></p> <p>Protect all corners Use walk off mats <b>Scrub Floor</b> Use Flat mop to prevent finish on cove base  <u>Standard</u> Floor Finish</p>	<p><b>New Look Protection</b></p> <p>Protect all corners Use walk off mats <b>Strip Floor Finish</b> Use Flat mop to prevent finish on cove base  Standard Floor Finish</p>	<p><b>New Look Ultra Protection</b></p> <p>Protect all corners Use walk off mats <b>Strip Floor Finish</b> Use Flat mop to prevent finish on cove base  <b>RFC Vinyl Care System</b> (Never strip again!)</p>
	(Good)	(Better)	(Best)
<b>9" x 9" Asbestos Tile</b> Rooms: 10, 20-28, 54-57, Copy Room	\$5,360	\$11,613	\$16,259
<b>VCT Tile (12" x 12")</b> Rooms: Rms 5-7, 19, Counselor, Main Office Hallway	\$1,056	\$2,023	\$2,938
(taxes included) <b>Total</b>	<b>\$6,416</b>	<b>\$13,636</b>	<b>\$19,197</b>

**Recommended!**

**Job Order Notes:**

\*All items removed from floor prior to arrival or additional charges may apply.

Signature \_\_\_\_\_ Date \_\_\_\_\_

All items are subject to the standard tax rate. Please make checks payable to Reliable Floor Care, LLC (RFC). A \$50 fee for NSF checks. All invoices are payable within 30 days of invoice date and there may be a 10% interest charge added to balances that are beyond 10 days overdue. RFC is NOT responsible for pre-existing conditions that may become present after the work is performed. By signing this form, I agree that I am authorized to have this work performed at the above service location and agree to the terms of RFC, found at ReliableFloorCare.com/terms. RFC will perform the work agreed to within a timely manner. Some services have minimums and cannot be chosen a la carte. Thank you for your business and the opportunity to serve you!



**Reliable Floor Care**  
 W229N1680 Westwood Dr, Ste B  
 Waukesha, WI 53186  
 Office: (262) 558-5000

**Proposal**

Date:	Order No.
2/26/2024	27217

ReliableFloorCare.com

Customer Information	Service Location	Reliable Floor Care Rep:	
Name: River Valley School District Phone: - Loren Glasbrenner	<b>RV Schools</b> 660 Varsity Blvd Spring Green, WI 53588	<b>Sam Hughes</b>	(608) 888-8082
<p><b><u>VCT (Vinyl Composition Tile)</u></b></p> <p>Our promise to you is that our work is 100% guaranteed! We never compromise on quality and our team is professional, safe and friendly!</p> <p><b>RV High School</b></p>	<p><b>Durable Protection</b></p> <p>Protect all corners Use walk off mats <b>Scrub Floor</b> Use Flat mop to prevent finish on cove base  <u>Standard</u> Floor Finish</p> <p>(Good)</p>	<p><b>New Look Protection</b></p> <p>Protect all corners Use walk off mats <b>Strip Floor Finish</b> Use Flat mop to prevent finish on cove base  Standard Floor Finish</p> <p>(Better)</p>	<p><b>New Look Ultra Protection</b></p> <p>Protect all corners Use walk off mats <b>Strip Floor Finish</b> Use Flat mop to prevent finish on cove base  <b>RFC Vinyl Care System</b> (Never strip again!)</p> <p>(Best)</p>
	<p><b>9" x 9" Asbestos Tile</b></p> <p>Rooms: 13-15, 17, 18, 21-23</p> <p>\$3,093</p>	\$6,701	\$9,381
<p><b>VCT Tile (12" x 12")</b></p> <p>Rooms: 12, 16, 19-20, 24-34, 52-55, 57, 59-65, 69-71, Locker Room Entrances (2)</p> <p>\$15,351</p>	\$28,143	\$41,447	
(taxes included) <b>Total</b>	<b>\$18,444</b>	<b>\$34,844</b>	<b>\$50,828</b>

**Recommended!**

**Job Order Notes:**

\*All items removed from floor prior to arrival or additional charges may apply.

Signature \_\_\_\_\_ Date \_\_\_\_\_

All items are subject to the standard tax rate. Please make checks payable to Reliable Floor Care, LLC (RFC). A \$50 fee for NSF checks. All invoices are payable within 30 days of invoice date and there may be a 10% interest charge added to balances that are beyond 10 days overdue. RFC is NOT responsible for pre-existing conditions that may become present after the work is performed. By signing this form, I agree that I am authorized to have this work performed at the above service location and agree to the terms of RFC, found at [ReliableFloorCare.com/terms](http://ReliableFloorCare.com/terms). RFC will perform the work agreed to within a timely manner. Some services have minimums and cannot be chosen a la carte. Thank you for your business and the opportunity to serve you!



**Reliable Floor Care**  
 W229N1680 Westwood Dr, Ste B  
 Waukesha, WI 53186  
 Office: (262) 558-5000

**Proposal**

Date:	Order No.
2/26/2024	27217

ReliableFloorCare.com

Customer Information	Service Location	Reliable Floor Care Rep:	
Name: River Valley School District Phone: - Loren Glasbrenner	<b>RV Schools</b> 660 Varsity Blvd Spring Green, WI 53588	<b>Sam Hughes</b>	(608) 888-8082
<p><b><u>Terrazzo</u></b></p> <p>Our promise to you is that our work is 100% guaranteed! We never compromise on quality and our team is professional, safe and friendly!</p> <p><b>RV High School</b></p>	<p><b>Clean &amp; Protect</b></p> <p>Protect all corners Use walk off mats Strip Finish from Terrazzo (Will NOT remove Coating)</p> <p>Buff &amp; Polish</p> <p>RFC Stone Care Polish</p>	<p><b>Clean, &amp; Polish</b></p> <p>Protect all corners Use walk off mats Strip Finish from Terrazzo <b>Removes Coating</b></p> <p>Heavy Hone 60/120/200</p> <p><b>Satin Finish</b></p> <p>RFC Stone Care System</p>	<p><b>New Look &amp; Ultra Protection</b></p> <p>Protect all corners Use walk off mats Strip Finish from Terrazzo <b>Removes Coating</b></p> <p>Heavy Hone 60/120/200/400</p> <p><b>Semi-Gloss Finish</b></p> <p>RFC Stone Care System</p>
	(Good)	(Better)	(Best)
Hallways (Corridors and Vestibules) and Cafeteria (~22,000 sqft)*	\$26,633	\$99,873	\$107,641
Entrance A Repairs - Fill cracks and pits with color matched terrazzo (not perfect match) (Between Doors only)	<i>Not Included in Total</i>	<i>Not Included in Total</i>	<i>Not Included in Total</i>
	\$5,285	\$3,390	\$3,390
<b>*NO specific repairs listed - BUDGET Suggestion \$28,665</b>		<i>Not Included in Total</i>	
		\$28,665	
Since cove base is in hallway, our machines can't get up to the edge without removing base			
(taxes included) <b>Total</b>	<b>\$26,633</b>	<b>\$99,873</b>	<b>\$107,641</b>

**Recommended!**

**Job Order Notes:**

\*Color match isn't perfect. Cove Base remaining in hallway prevents our equipment from getting within 1/2"

Signature \_\_\_\_\_ Date \_\_\_\_\_

All items are subject to the standard tax rate. Please make checks payable to Reliable Floor Care, LLC (RFC). A \$50 fee for NSF checks. All invoices are payable within 30 days of invoice date and there may be a 10% interest charge added to balances that are beyond 10 days overdue. RFC is NOT responsible for pre-existing conditions that may become present after the work is performed. By signing this form, I agree that I am authorized to have this work performed at the above service location and agree to the terms of RFC, found at ReliableFloorCare.com/terms. RFC will perform the work agreed to within a timely manner. Some services have minimums and cannot be chosen a la carte. Thank you for your business and the opportunity to serve you!

River Valley Elementary  
Floor Plan  
Spring Green, WI

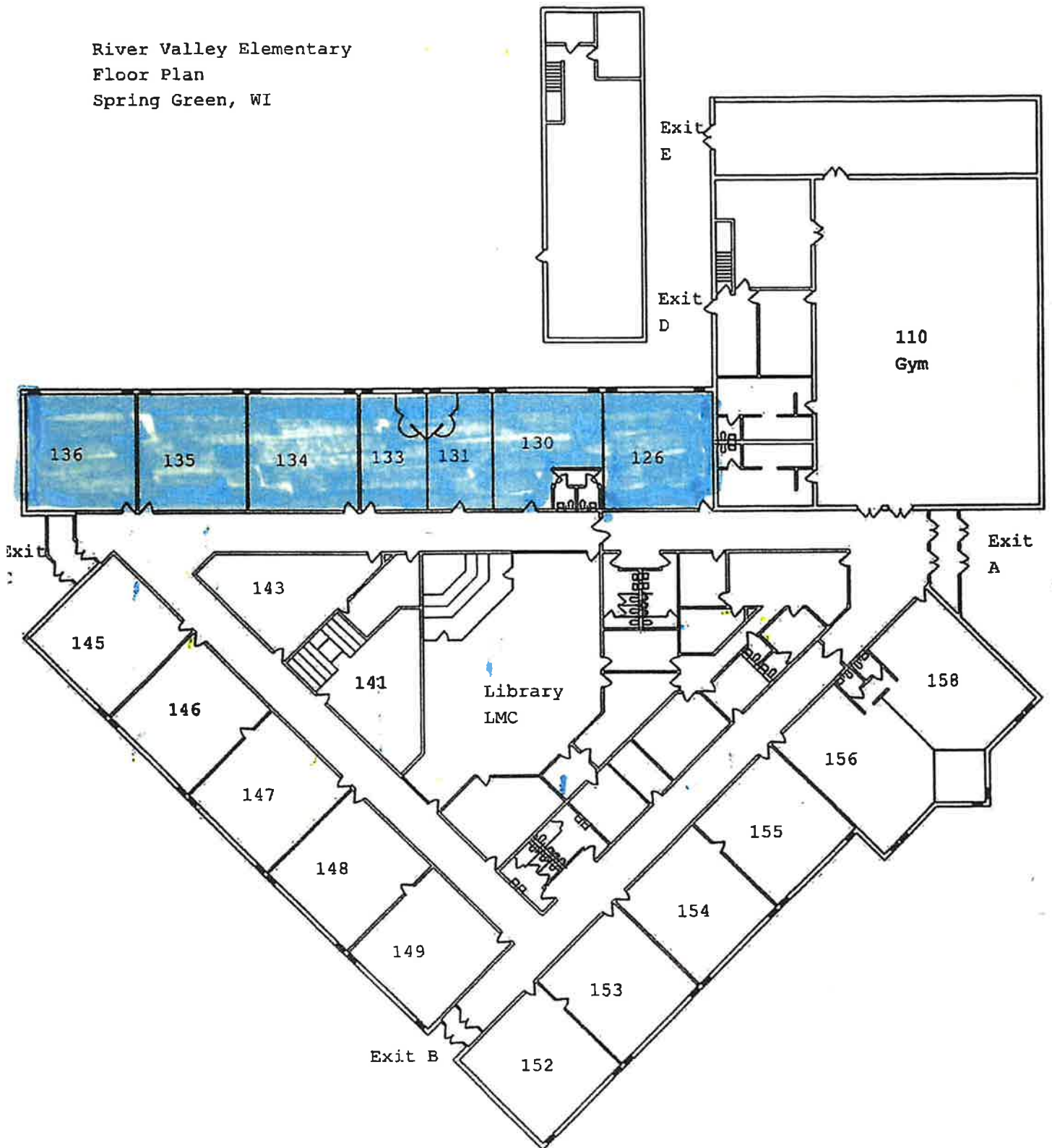

# RIVER VALLEY MIDDLE SCHOOL

JAMES RADTKE, PRINCIPAL  
 DAN MACHOVEC, ADMINISTRATIVE BUILDING COORDINATOR  
 HOLLY LOCHNER, COUNSELOR



River Valley High School  
Floor Plan A

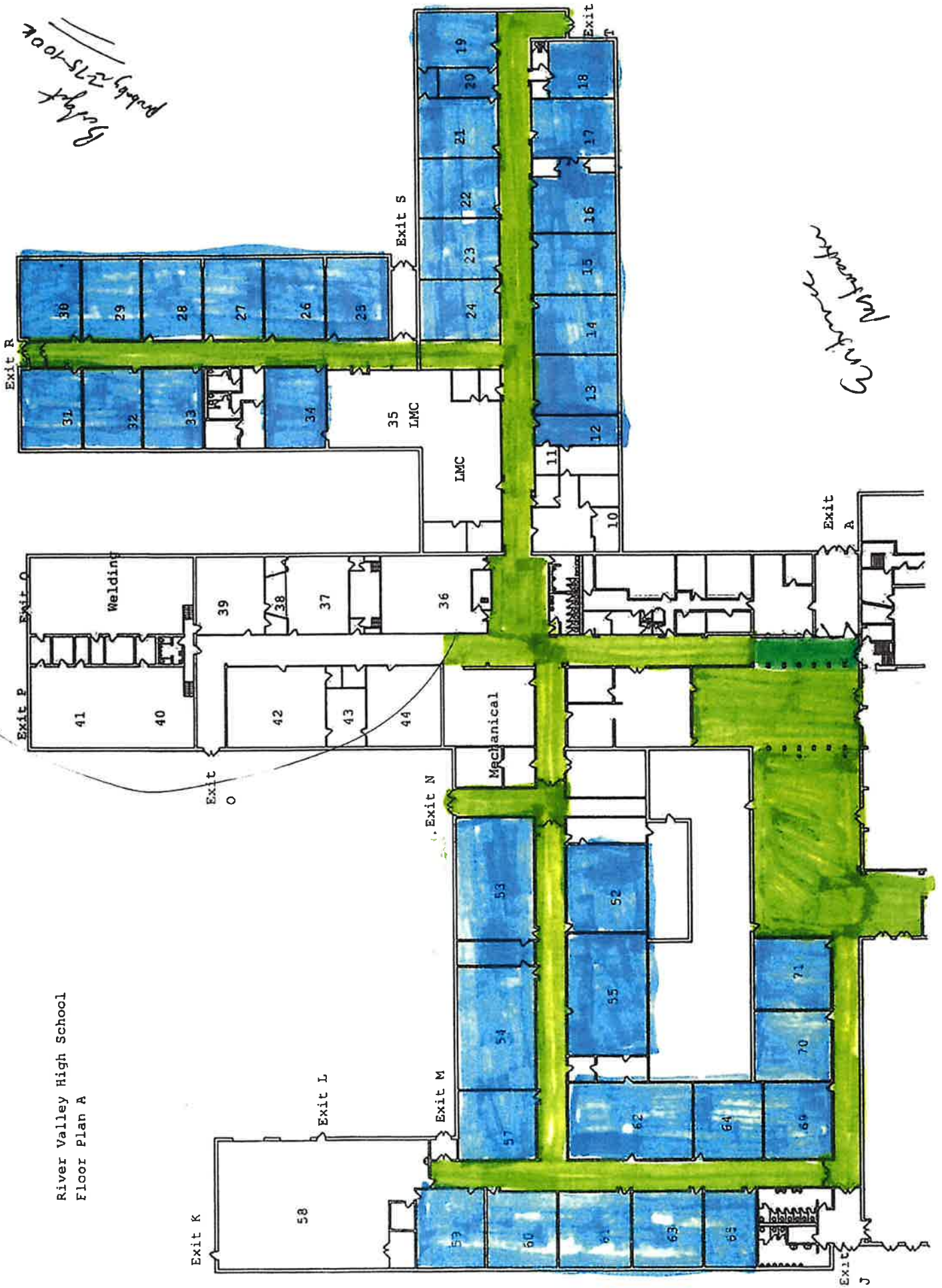

*Budget  
Probably 275-300K*

*Construction  
Markings*



River Valley High School  
Floor Plan B

